



# FY SERIES

Fabricated Y Strainer  
ASME Design



Water



Desalination



Chemicals



Electronics



Food & Beverage



Oil/Gas



Air/Gas



Inks/Paints/  
Coatings



Power



Coolants



Pulp & Paper

## FY SERIES Fabricated Y Strainer

- Fabricated Y strainers from 2" to 24" (larger sizes are available)
- Designed in accordance with ASME Section VIII Div. 1.
- Standard design pressures include 150psi, 300psi and ANSI 150 & 300.
- Vessels available in carbon or stainless steel 304 or 316.
- Hinged covers are available for quick opening.
- Swing bolt opening available for quick opening.

For pricing or to order, please contact



204 North Link Lane #7  
Fort Collins, CO 80524  
Office 970-204-4758  
Fax 970-204-4764

[brandon@industrialfiltersource.com](mailto:brandon@industrialfiltersource.com)

# FY SERIES

Fabricated Y Strainer  
ASME Design

# MECHANICAL SPECIFICATIONS

## Housing Specifications:

Inlet/Outlet  
2" – 24" Flanged  
Drain  
1/2" NPT

## Certifications:

-U  
-UM  
-CE  
-NB  
-CRN

MODEL	FLOW RATE (GPM @ 2PSI)	A (FACE TO FACE)	B (HEIGHT)	C (REMOVAL HEIGHT)
FY-2-150	120	12"	6"	11"
FY-2 ½"-150	190	13"	6 ½"	12"
FY-3-150	300	15"	10"	14"
FY-4-150	525	18"	12"	17"
FY-5-150	750	22"	13"	21"
FY-6-150	1200	24"	16"	23"
FY-8-150	2050	30"	19"	29"
FY-10-150	3250	34"	23"	33"
FY-12-150	4600	37"	25"	36"
FY-14-150	5550	42"	28"	41"
FY-16-150	7300	45"	30"	44"
FY-18-150	9300	50"	35"	49"
FY-20-150	11100	53"	40"	52"
FY-24-150	15850	63"	44"	62"

Dimensions given are typical only. For critical requirements, please contact factory for a certified drawing.

## AVAILABLE SCREEN SIZES

PERFORATED SIZES AVAILABLE	MESH SIZES AVAILABLE
1/32"	20
3/64"	30
1/16"	40
3/32"	60
1/8"	80
3/16"	100
3/4"	120
1/2"	160
	200
	DOWN TO 5 MICRON

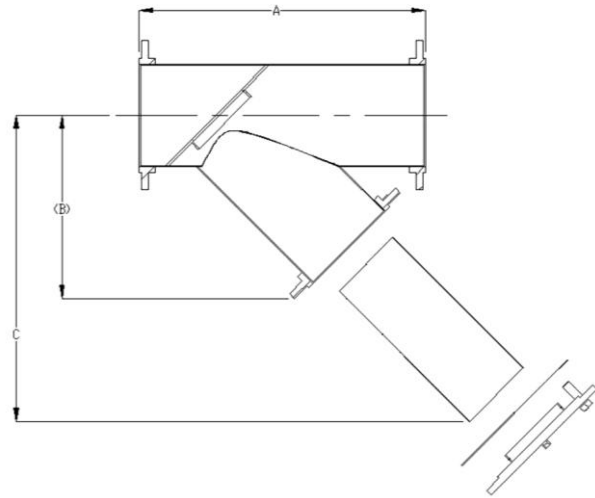

## AVAILABLE PRESSURE RATINGS

PRESSURE	PSI @ TEMP WOG
150#	150psi @ 250°F
300#	300psi @ 250°F
150# ANSI	285psi @ 100°F (CS) 275psi @ 100°F (SS)
300# ANSI	740psi @ 100°F (CS) 720psi @ 100°F (SS)

## FIL-TREK PRODUCT NOMENCLATURE

S6	FY	16	150	1/8P	-
MATERIAL	MODEL	NOZZLE SIZE	DESIGN PRESSURE	SCREEN	AVAILABLE OPTIONS
(BLANK) – CARBON STEEL	FY	SEE CHART	150 – 150 PSI	SEE CHART	HC – HINGE COVER
S4 – SS304			150A – 150 ANSI PSI		SW – SING BOLT COVER
S6 – SS316			300 – 300 PSI		BV – BLOWOUT VALVE
			300A – 300 ANSI PSI		

For pricing or to order, please contact



204 North Link Lane #7  
Fort Collins, CO 80524  
Office 970-204-4758  
Fax 970-204-4764

brandon@industrialfiltersource.com