



Fil-Trek

SBI SERIES

Inline Simplex Strainer
ASME Design



Water



Desalination



Chemicals



Electronics



Oil/Gas



Air/Gas



Inks/Paints/ Coatings



Power



Coolants



Pulp & Paper

SBI SERIES Inline Simplex Strainer

- Inline strainer basket housing.
- ASME designed inline basket housing.
- Basket flow inside out to trap particulate.
- 150 psig (10.3bar) @ 250°F(121.1°C) operating pressure standard.
- Higher designer pressures available
- Available with mesh liners and wedge wire
- Vessels available in carbon or stainless steel 304 or 316.
- Swing bolt closure allows for quick element change out.
- Davit used on larger vessels to facilitate basket change out.

For pricing or to order, please contact



204 North Link Lane #7
Fort Collins, CO 80524
Office 970-204-4758
Fax 970-204-4764

brandon@industrialfiltersource.com

SBI SERIES

Inline Simplex Strainer
ASME Design

Housing Specifications

Inlet/Outlet
2" – 24" Flanged

Dirty Drain
1" NPT

Clean Drain
1" NPT

Vent
1/2" NPT

Gauges
1/2" NPT

Certifications

U
UM
CE
NB
CRN

SBI SERIES

MODEL DETAILS

MODEL	FLOW RATE (GPM)	MAX INLET/OUTLET	A (FLOOR TO INLET/OUTLET)	B (FLOOR TO TOP)	C (FACE TO FACE)	D (INSIDE DIAMETER)	SHIPPING WEIGHT (LBS)
SBI6-2F-150	105	2"	12"	20"	12.75"	6.375"	222
SBI8-3F-150	275	3"	13"	22"	14"	8.375"	244
SBI8-4F-150	475	4"	15"	25"	16"	8.375"	277
SBI10-5F-150	670	5"	18"	27"	18"	10"	299
SBI10-6F-150	1,080	6"	18"	30"	20"	10"	332
SBI12-8F-150	1,850	8"	22"	45"	22"	12"	499
SBI16-10F-150	2,900	10"	26"	57"	32"	16"	632
SBI18-12F-150	4,100	12"	29"	63"	35"	18"	698
SBI20-14F-150	5,000	14"	34"	67"	37"	20"	742
SBI24-16F-150	6,500	16"	37"	73"	42"	24"	809
SBI24-18F-150	8,300	18"	41"	75"	46.5"	24"	831
SBI30-20F-150	9,900	20"	47"	83"	52"	30"	920
SBI36-24F-150	14,150	24"	56"	87"	64"	36"	964

Dimensions given are typical only. For critical requirements, please contact factory for a certified drawing.

ADDITIONAL MODEL CONFIGURATIONS

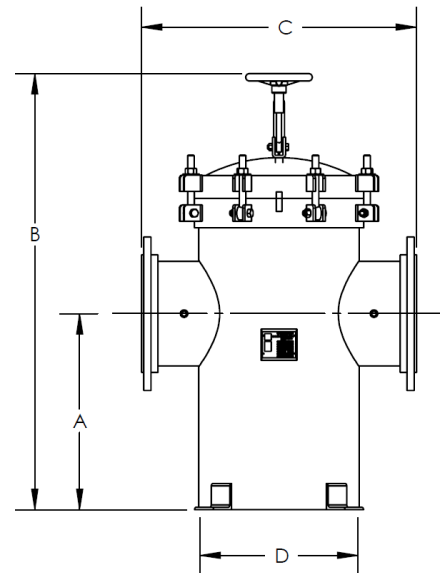
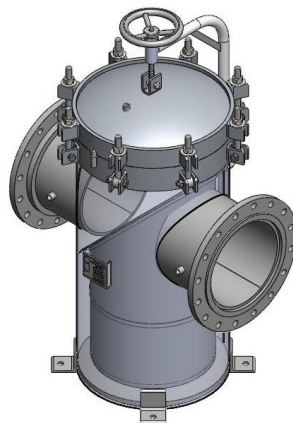

MATERIAL OF CONSTRUCTION	MAX. OPERATING PRESSURE (PSI @250°F)	MAX. DESIGN TEMP
CARBON STEEL	150 psi (10.3bar)	300°F (150°C)
304 STAINLESS STEEL	150 psi (10.3bar)	300°F (150°C)
316 STAINLESS STEEL	150 psi (10.3bar)	300°F (150°C)

MODEL NOMENCLATURE

S6	SBI	24	16F	150	LA
MATERIAL	MODEL	DIAMETER OF HOUSING	SIZE OF INLET/OUTLET	PRESSURE RATING	MOUNTING TYPE
(BLANK) – CARBON STEEL	SBI	SEE CHART	(FLANGE)	150	LA – ANGLE IRON LEGS
S4 – SS304			SEE CHART	A150	LN – NO LEGS
S6 – SS316				300	(BLACK) – FLAT BOTTOM
				A300	

For pricing or to order, please contact



204 North Link Lane #7
Fort Collins, CO 80524
Office 970-204-4758
Fax 970-204-4764

brandon@industrialfiltersource.com