



# Fil-Trek



## SBO SERIES

Offset Simplex Strainer  
ASME Design



Water



Desalination



Chemicals



Electronics



Food & Beverage



Oil/Gas



Air/Gas



Inks/Paints/  
Coatings



Power



Coolants



Pulp & Paper

## SBO SERIES Offset Simplex Strainer

- Strainer Basket Housing
- ASME designed offset strainer basket housings.
- Basket flow inside out to trap particulate.
- Designed for extended periods between basket change outs.
- 150psig (10.3bar) @ 250°F(121.1°C) operating pressure standard
- Higher pressures are available.
- Available with mesh liners and wedge wire.
- Vessels available in carbon or stainless steel 304 or 316.
- Swing bolt closure allows for quick basket change out.
- Davit used on larger vessels to facilitate basket removal

For pricing or to order, please contact



204 North Link Lane #7  
Fort Collins, CO 80524  
Office 970-204-4758  
Fax 970-204-4764

[brandon@industrialfiltersource.com](mailto:brandon@industrialfiltersource.com)

# SBO SERIES

Offset Simplex Strainer  
ASME Design

## Housing Specifications:

Inlet/Outlet  
2" – 24" Flanged  
Dirty Drain  
1" NPT  
Clean Drain  
1" NPT  
Vent  
1/2" NPT  
Gauge Ports  
1/2" NPT

## Certifications:

-U  
-UM  
-CE  
-NB  
-CRN

# MECHANICAL SPECIFICATIONS

MODEL	A (FLOOR TO INLET/OUTLET)	B (FLOOR TO TOP)	C (FACE TO FACE)	D (INSIDE DIAMETER)
SBO6-2F-150	12"	4"	20"	12.75"
SBO8-3F-150	13"	5"	22"	14"
SBO8-4F-150	15"	6"	25"	16"
SBO10-5F-150	18"	7"	27"	18"
SBO10-6F-150	18"	7"	30"	20"
SBO12-8F-150	22"	8"	45"	22"
SBO16-10F-150	26"	9"	57"	32"
SBO18-12F-150	29"	10"	63"	35"
SBO20-14F-150	34"	11"	67"	37"
SBO24-16F-150	37"	13"	73"	42"
SBO24-18F-150	41"	14"	75"	46.5"
SBO30-20F-150	47"	15"	83"	52"
SBO36-24F-150	56"	16"	87"	64"

Dimensions given are typical only. For critical requirements, please contact factory for a certified drawing.

MODEL	FLOW RATE (GPM)	SHIPPING WEIGHT (LBS)	INLET/OUTLET SIZE
SBO6-2F-150	105	222	2"
SBO8-3F-150	275	244	3"
SBO8-4F-150	475	277	4"
SBO10-5F-150	670	299	5"
SBO10-6F-150	1080	332	6"
SBO12-8F-150	1850	499	8"
SBO16-10F-150	2900	632	10"
SBO18-12F-150	4100	698	12"
SBO20-14F-150	5000	742	14"
SBO24-16F-150	6500	809	16"
SBO24-18F-150	8300	831	18"
SBO30-20F-150	9900	920	20"
SBO36-24F-150	14150	964	24"

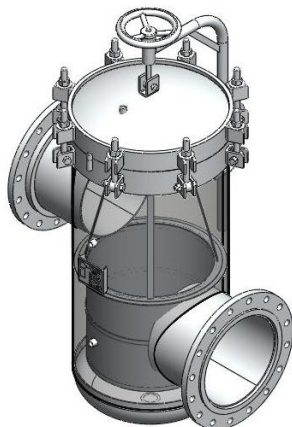
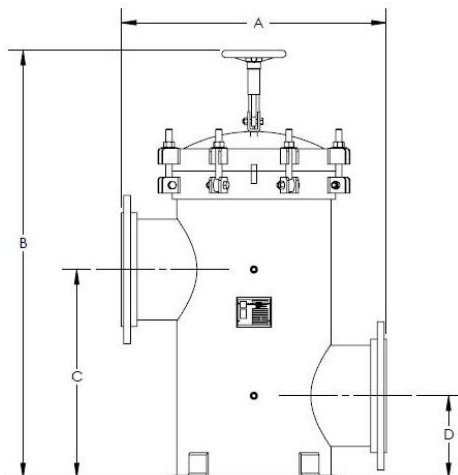

## FIL-TREK PRODUCT NOMENCLATURE

S6	SBO	30	20F	150	LA
MATERIAL	MODEL	DIAMETER OF HOUSING	SIZE OF INLET/OUTLET	PRESSURE RATING	MOUNTING TYPE
(BLANK) – CARBON STEEL	SBO	SEE CHART	(FLANGE)	150	LA – ANGLE IRON LEGS
S4 – SS304			SEE CHART	A150	LN – NO LEGS
S6 – SS316				300	(BLACK) – FLAT BOTTOM
				A300	

For pricing or to order, please contact



204 North Link Lane #7  
Fort Collins, CO 80524  
Office 970-204-4758  
Fax 970-204-4764

brandon@industrialfiltersource.com